

WHOLE HOUSE

iSpring Reusable Spin-down Sediment Water Filter

Jumbo size with optional Auto Flushing Module

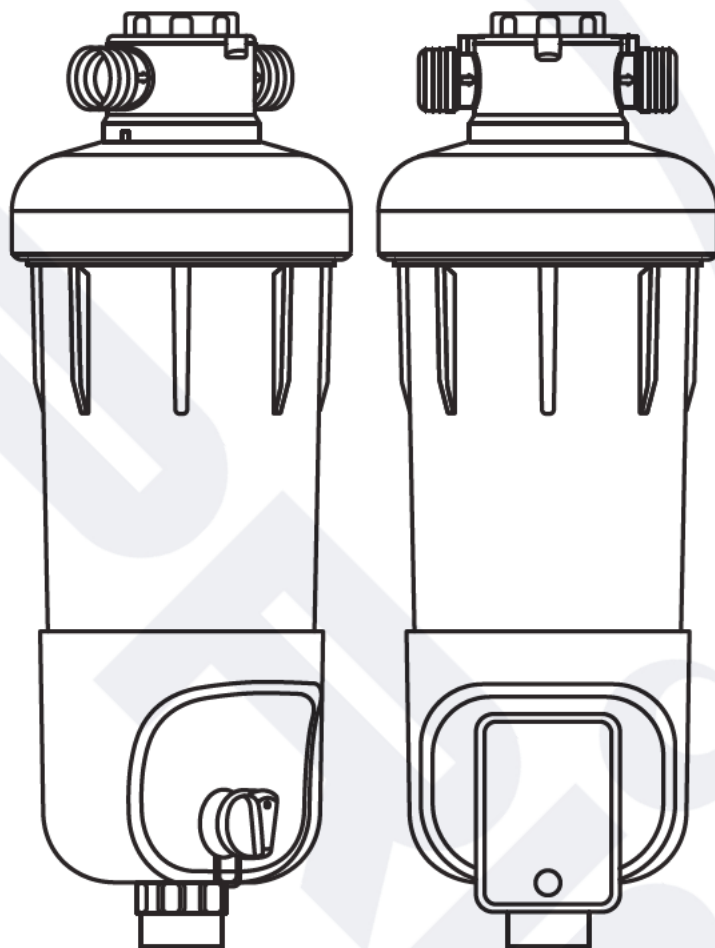

Model: WSP-J / WSP-ARJ

Installation Instructions & User Manual

Ver. 12/2021



iSpring Water Systems



Copyright ©2005-2022 ISPRING WATER SYSTEMS, LLC. All rights reserved.



We stand behind our products

Since 2005, iSpring has been dedicated to providing high-quality drinking water to families across the United States. We provide various residential faucets and water filtration systems that purify your water in everyday life and deliver pure, healthy, and tasty water to you and your family.

At iSpring, we strive to develop products to the highest of standards and aim to make excellent drinking water accessible for all households. With affordable pricing, reliable quality, prompt delivery, and top-notch customer service, we hope to assist in bringing you great water for years to come.

Prior to Installation

Read this instruction manual carefully prior to installation.

Keep this manual readily available for future reference.

Table of Contents

User Information.....	3
Overview.....	4
Packing List.....	4
Product Features.....	4
Installation.....	5
Product Instructions & Maintenance.....	7
Product Mounting (Optional).....	7
Troubleshooting.....	8

Warranty

Warranty.....	9
Warranty Registration.....	10

User Information

The user must adhere to the installation specifications described in this Product Installation and Operation Manual (hereinafter referred to as the "instruction manual"). iSpring is not responsible for damage, loss, or injury resulting from neglect, improper maintenance, or unauthorized modification of products.









- This product is designed for residential use only. Contact iSpring customer service to inquire about usage in non-residential settings.
- The operating temperature range is 40 - 100°F. If the water temperature or ambient temperature falls below 40°F, immediately shut off the inline water supply, turn off the inline water adapter, and drain the remaining water from the system.
- In case of malfunction due to damage or failure of the power supply system, unplug the system immediately and contact iSpring customer service for guidance.
- If leaking occurs, shut off the inline water supply. Then unplug the system and contact iSpring customer service.
- Use only authorized iSpring parts and filters. Using unauthorized or aftermarket components will void the product warranty.
- It is recommended that users check external fittings and connections regularly to ensure all components are secure and operating correctly.
- Unauthorized modification and disassembly are strictly prohibited and will void the warranty.
- Never touch the power cord connector when your hands are wet, as this may result in electric shock.

Overview

The iSpring WSP-J/WSP-ARJ filters out particulate, sediment, rust, floating objects and other pollutants in water. It should be installed as central water purification pre-filter to protect terminal equipment and appliances such as downstream pipelines, water purifiers, water heaters, wall-hung boilers, washing machines, and showerheads.

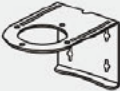
The iSpring WSP-J/WSP-ARJ is flushable and reusable. A toggle switch allows particles trapped in the filter to be flushed out with no need to shut down the water supply first.

Packing List

1. Filter Body	2. Housing Wrench	3. 3/8" Quick Fitting	4. Manual Ball Valve Handle	5. Mounting Bracket
				
	6. 3/8" PE Tubing	7. User Manual	8. Expansion Anchors x4	9. Mounting Screw
				

Product Features

- The system is constructed with 316L food grade stainless steel precision filter mesh.
- Core components are made of pressure-resistant materials.
- Explosion-proof transparent housing provides clear visibility, great intuitiveness, and convenience for users.
- Universal fittings can be easily installed and adaptable to other applications.

Product Specification

Model Name	WSP-J/WSP-ARJ
Flow Rate	up to 25 gal/min.
Feed Water Temperature	40 - 100°F
Connector Size	1" MNPT, 3/4" FNPT, and 3/4" Push-fit

Auto Flushing Module Specification

Dimension	4.2 " (L) * 3 " (W) * 2.4" (D)
Power	100 - 240V 5V/1A or 3 * AA Battery
Temperature	40 - 100°F

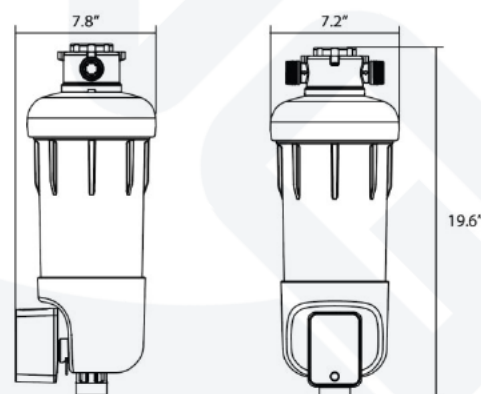

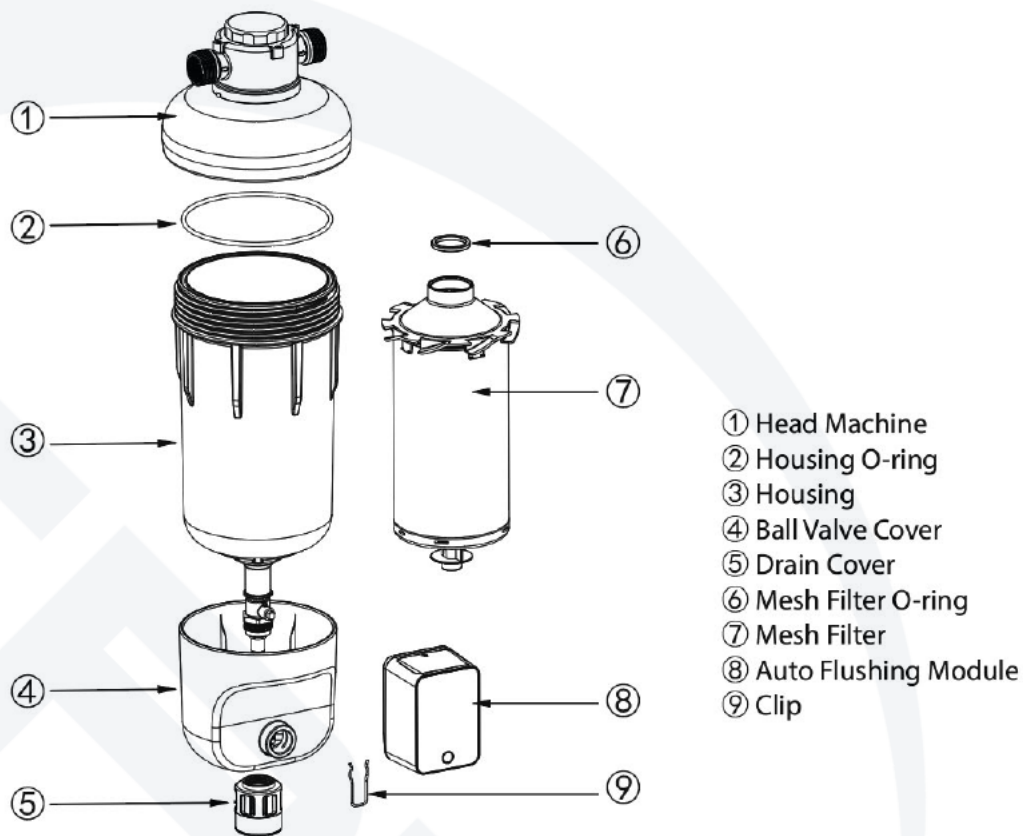

Installation

- A. Close the main inlet valve and drain the remaining water from the pipe.
- B. While installing, make sure that the direction of water flow marked on the valve body aligns with the direction of water flow in the pipeline.
- C. After the filter is installed, the filter housing assembly must be kept upright.
- D. Check for any water leakage at the joints.

Note:

- This system is only suitable for 40 - 100 °F municipal tap water; please do not use with wastewater and corrosive liquids;
- The unit comes with two types of threads on both ends: 1" MNPT, 3/4" FNPT, and 3/4" Push-Fit to fit in different plumbing sizes.
- During installation, make sure that the direction of water flow marked on the valve body is consistent with the flow direction of the pipeline.
- This product should not be installed outdoors. It should be located in a dry indoor environment away from direct sunlight, heat sources, fuel oils, and chemicals.
- Make sure to apply the plumber's tape evenly.
- When tightening the hex nut with a wrench, make sure that other parts are not turning with it.

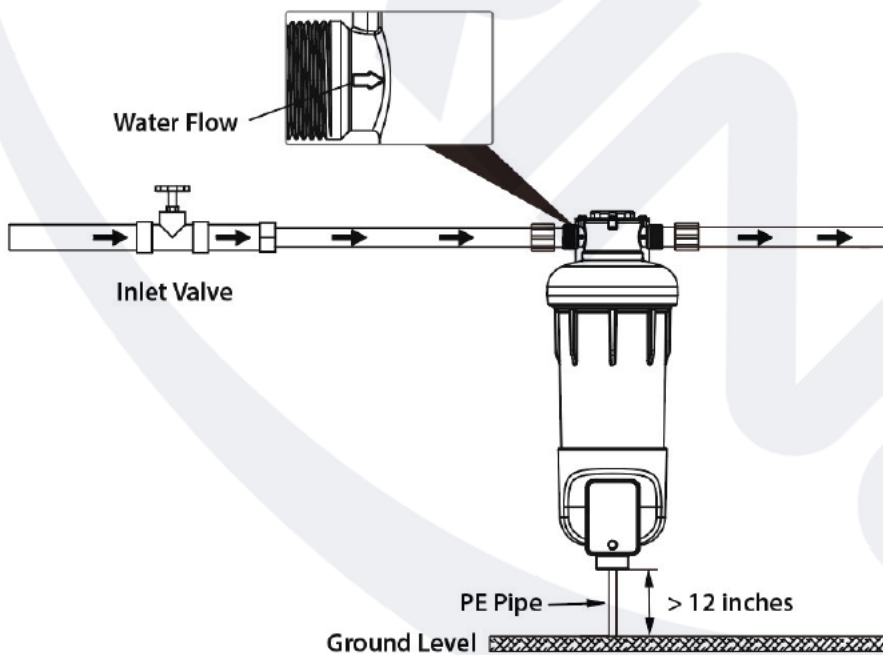
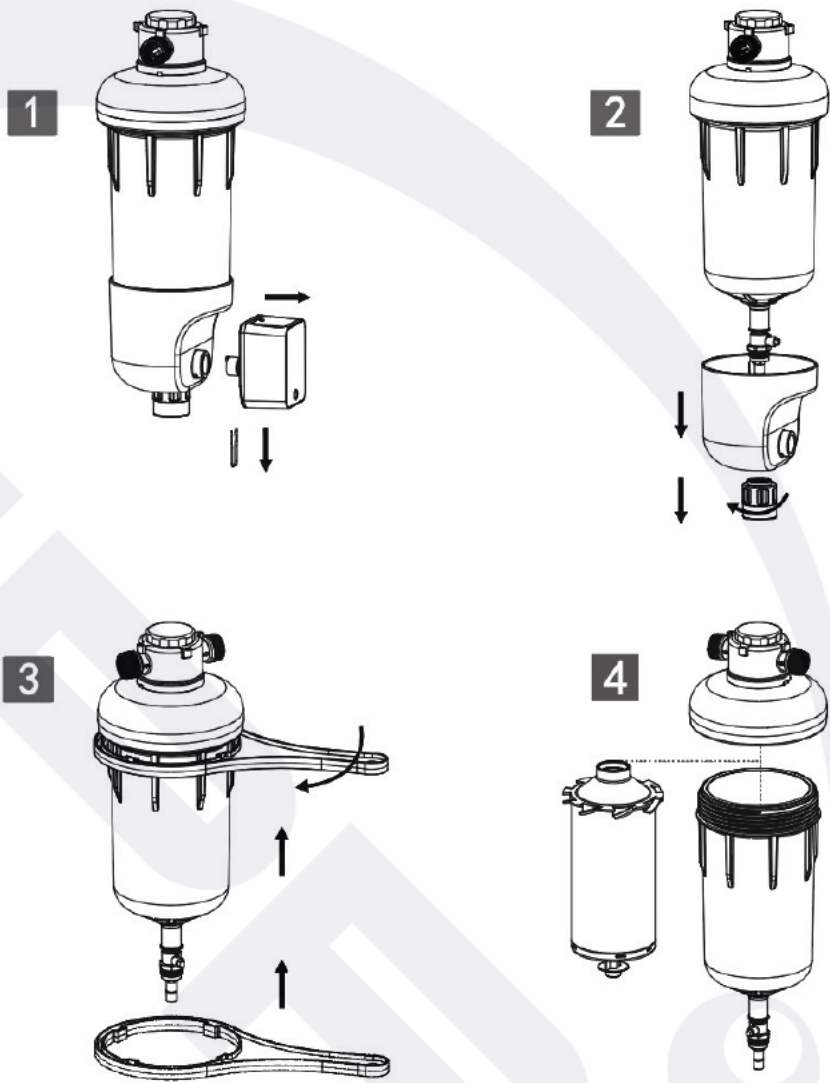

Product Instructions & Maintenance

- After installation, open the inlet water main valve to allow water to flow into the filter.
- Before flushing, ensure that there is a reliable drainage system. You can also flush the drain water into a suitable container.
- Turn the drain valve knob to flush the drain.
- Press the on/off button to turn the auto flushing module (optional) on, then press the "drain" button to flush the drain.
- We recommend flushing at least once a week for 30 seconds each time, depending on the incoming water quality.
- To clean the filter cartridge after being used continuously for 8-12 months, remove the stainless steel filter mesh and clean it with a brush or soak it in vinegar. For better operation, we recommend it to be professionally cleaned.

We are committed to providing you with complete and reliable products and services. Please contact us immediately if you have any questions.

Product Mounting (Optional)

- A. Take the measurement and choose a proper location.
- B. Drill four 5/16" diameter holes on the wall based on the positioning of the bracket.
- C. Install the expansion anchors through the drilled holes.
- D. Mount the filter to the bracket with four mounting screws (part No. 10) that came with the package. The bracket can be mounted either way, as shown below.

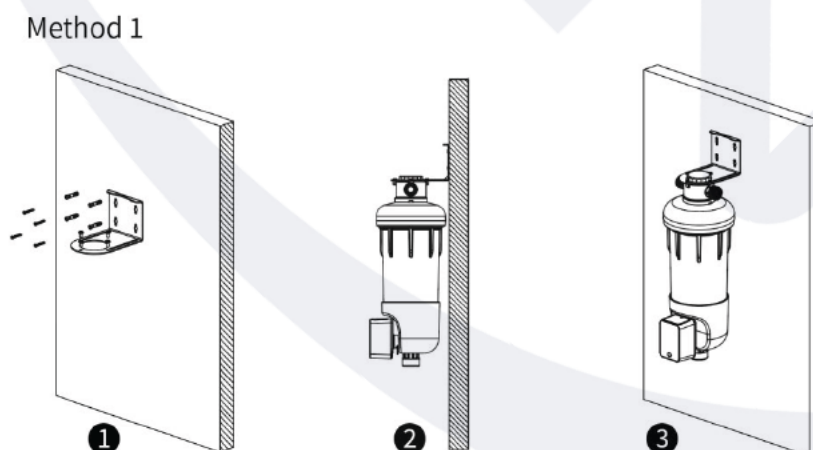

Method 2

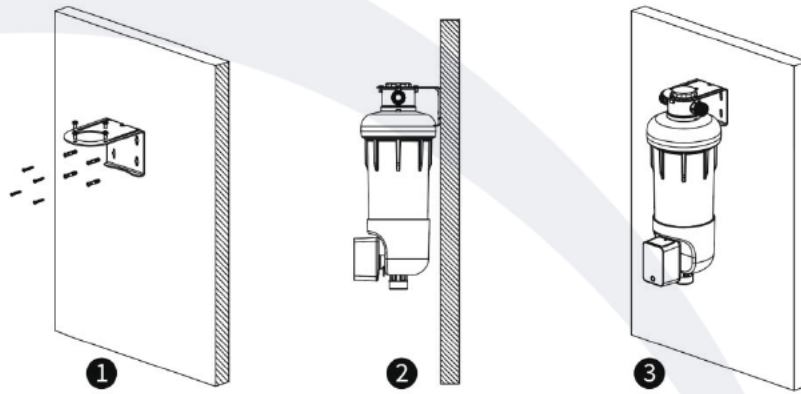

Troubleshooting

Issue	Possible Causes	Solutions
No water	The water source doesn't have water. The Inlet water valve isn't open.	Wait for the water to come back on. Open the inlet valve.
Low outlet flow	The inlet water valve isn't fully open. The surface of the filter is partially blocked.	Fully open the inlet valve. Flush the filter mesh to remove debris.
Water leakage at the joint	Filter parts have been disassembled. Loose parts at the leaking location. Not enough plumber's tape on the threads. O-rings at the leaking location are damaged.	Check to see if the seal is misaligned or missing. Retighten the threaded joint with a wrench. Reapply plumber's tape and tighten. Replace O-rings.
No pressure values display	The pressure gauge is damaged. The inlet water valve isn't open.	Replace pressure gauge. Open the inlet valve.

Warranty

This Limited Warranty extends to the original purchaser of the system only. This warranty covers all Manufacturer-supplied items only that prove to be defective in material, workmanship, or factory preparation. This warranty covers parts only; all labor is excluded from this warranty, including, but not limited to, services related to the removal, replacement, installation, adjustment, maintenance, and/or repair of the unit or its components items. Excludes all non-Manufacturer labor required for any servicing of the unit, including, but not limited to, servicing related to installation, adjustment, maintenance, and repair of the unit. This warranty applies only for the first full calendar year from the date of purchase. The following items are excluded from this warranty: membranes, filters, O-rings, and all other parts or components that require regular replacement due to ordinary usage.

Disclaimers: This Limited Warranty applies only if the system is installed, used, and maintained in compliance with all instructions and requirements enclosed with the system. This warranty will be void for failure to observe the following conditions:

1. The system is to be used with a potable water supply only.
2. Feed water pressure to the unit is no less than 45 psi (30 psi for systems with built-in booster pump) and no greater than 70 psi.
3. The system is to be used on water supplies with chlorine concentrations of 1.0 mg/L (ppm) or less.
4. Feed water temperature to the unit must be no less than 41°F and no more than 100°F.
5. Total dissolved solids (TDS) in feed water must be less than 750 mg/L (ppm).
6. Feed water must have a pH between 4 and 8.
7. Turbidity must be less than 1.0 NTU.
8. SDI must be less than 5.
9. Feed water must be completely free of iron, manganese or hydrogen sulfide.

While the testing was performed under standard laboratory conditions, actual performance may vary. The Manufacturer does not know the characteristics of your water supply. The quality of water supplies may vary seasonally or over a while. Your water usage may differ as well. Water characteristics can also change if the drinking water appliance is moved to a new location. The Manufacturer assumes no liability for determining the proper equipment necessary to meet your requirements, and we do not authorize others to assume such obligation on our behalf.

This Limited Warranty does not cover any Manufacturer-supplied items that are defective due to the use of improper parts, equipment, or materials. This warranty does not cover alterations or modifications of the unit or failure of a unit caused by such alterations and modifications.

This Limited Warranty does not cover malfunctions of the unit due to tampering, misuse, alteration, lack of regular maintenance, misapplication, fouling due to hydrogen sulfide, manganese or iron, scaling from excessive hardness, turbidity greater than 1.0 NTU, Silt Density Index (SDI) greater than 5.0 SDI, or excessive membrane hydrolysis due to chlorine levels over 1.0 mg/L (ppm). In addition, damage to the unit due to fire, accident, negligence, the act of God, or events beyond the Manufacturer's control are not covered by this warranty.

Incidental and Consequential Damages Limitation: The Manufacturer will not be responsible for any incidental or consequential damages as a result of the failure of this unit to comply with express or implied warranties or any defect in the unit, including but not limited to lost time, inconvenience, damage to personal property, loss of revenue, commercial losses, postage, travel, telephone expenditures, or other losses of this nature. If some states do not allow the exclusion or limitation of incidental or consequential damages, you may choose to return the system. If you decide to keep it, you insist this exclusion STILL apply to you.

Owner's Warranty Responsibilities: As a condition of this Limited Warranty, the owner must ensure that periodic maintenance of the system is performed as described in the literature enclosed with the system. Neglect, improper maintenance, abuse, modification, or alteration of the unit will invalidate this Warranty. Should your unit develop a defect or otherwise fail to perform under this warranty, you should contact the retailer from whom the product was originally purchased.

Implied Warranties: The implied at-law warranties of merchantability and fitness for a particular purpose shall terminate on the date one year after the date of purchase.

NOTE: IN CASE SOME STATES DO NOT ALLOW LIMITATIONS ON HOW LONG AN IMPLIED WARRANTY LASTS, YOU MAY CHOOSE TO RETURN THE SYSTEM. IF YOU CHOOSE TO KEEP IT, YOU AGREE THAT THE ABOVE LIMITATIONS STILL APPLY TO YOU.

Warranty Registration

To register your product for the warranty, visit our website at 123filter.com and go to the "Warranty" tab.

We provide a 30-day money-back guarantee, a 1-year manufacturer warranty, and lifetime tech support for all of our products. However, we do not have the order information from websites other than 123Filter.com (Amazon, Home Depot, etc.), so please be sure to fill in that information upon registration of your system. If you have any questions or concerns about your product, please do not hesitate to call or email us, or put it in the notes/comments upon your warranty registration. Your satisfaction is our business!

If you are happy with our products and service, please show your support by writing a product review on Amazon, even just a single line. It takes you just a minute but means a lot to us. Thank you!



Atlanta, GA USA

iSpringFilter.com

For questions, comments, or technical support, contact us at:

support@123Filter.com

(678) 261-7611

Monday-Friday 8:30 a.m. - 5:30 p.m. EST