

Maintenance

- The Total Dissolved Solids (TDS) of water from this car wash system should be tested regularly to verify that the system is performing properly. If you notice a dramatic increase (~30 ppm) in the TDS value, it would be time to get your filter replaced.
- When the rinsing is finished, leave the remaining water in the filter housings to keep the deionization filters from drying out.

Filter Replacement

- Step 1:** Shut off the cold water supply. Place a bucket or towel under the system to catch any water spills. Use hot water and scent-free dish soap (optional) to clean the filter housing if needed. Rinse thoroughly.
- Step 2:** Twist the housing clockwise from the system using the housing wrench.
- Step 3:** Remove and dispose of all expired filters. Unwrap and install the new filters. Ensure the O-rings are properly seated. Tighten filter housings back on with the housing wrench. Do not over-tighten.
- Step 4:** Turn on the cold water supply. Flush the system into a bucket.
- Step 5:** Wait for the outlet water flow rate to become stable, and then shut off the cold water supply. The replacement is now complete.

Warranty Registration

To register your product for the warranty, visit our website at 123filter.com and go to the "Warranty" tab.

We provide a 30-day money-back guarantee, a 1-year manufacturer warranty, and lifetime tech support for all of our products. However, we do not have order information from websites other than 123Filter.com (Amazon, Home Depot, etc.). So, please fill in that information upon registering your system. If you have any questions or concerns about your product, please call or email us, or put it in the notes/comments upon registering your warranty. Your satisfaction is our business!

If you are happy with our products and service, please show your support by writing a product review on Amazon, even just a single line. It takes you just a minute, but it means a lot to us. Thank you!

iSpring Water Systems

678-261-7611
support@123filter.com
www.123filter.com
Atlanta, GA USA



iSpring WGB22BD Spot Free Deionization Car Wash System

Ver. 05/2022

Packing List

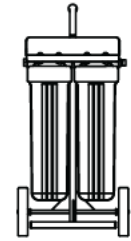

MODEL: WGB22BD



Garden Hose Quick Connector



Screw



Wrench



Filter Housing

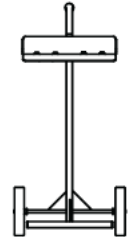

Moveable Stand

Part	Description	Quantity
Garden Hose Quick Connector	3/4" GHT	1
Screw	for moveable stand installation	4
Wrench (Model#AWR3)	housing wrench	1
Filter Housing	20" tall and 4.5" in diameter	2
Filter Cartridge (Model#FD25B)	deionization filter	2
Moveable Stand	comes in three parts, needs installation	1

Precautions

- Performance data was tested under standard laboratory conditions; actual performance may vary.
- This system is designed to be used on a cold supply ONLY and kept away from freezing environments.
- The installation must comply with all applicable local plumbing codes and/or regulations.
- This system is NOT designed for potable purposes. Do NOT use this system for any other uses except car washing.
- Choking hazard. Small parts are included in the package. Please keep the package out of the reach of small children at ALL times.

If you have any questions or concerns during the installation, please contact us at support@123filter.com or visit our help page at 123filter.com/support

Product Features

Stage	Filter	Filter Life	Purpose
1 st /2 nd	Deionization Filter (Model# FD25B)	Up to 12 months	Produces filtered water with zero or near zero TDS.
Note: The lifespan of cartridges depends on the incoming water quality and usage. The deionization filter needs to be replaced every 12 months due to its special properties.			

	Specification
Model	WGB22BD
Maximum Operating Temperature	140 °F
Incoming Water Pressure	20 - 100 psi
Incoming Water Temperature	60 - 77 °F
Service Flow Rate	Up to 2 GPM
*For residential use ONLY.	

Installation

This system works with 3/4" GHT garden hose fittings.

Step 1: Preparation

- Check the packing list to confirm all accessories are included. Contact the iSpring customer service team if any components are missing.
- Choose a suitable location for the system, either indoors or outdoors. It cannot be mounted and must ideally be placed on a flat surface. Ensure the system is installed ONLY using a cold water supply.
- Wash and dry your hands thoroughly to ensure all open cuts are covered. This prevents the filter cartridge and housing from becoming contaminated.

Note: This WGB22BD car wash system is easy to install. No additional tools are required.

Step 2: Assemble the Moveable Stand

The moveable stand comes in three parts, which must be assembled together using screws. Carefully follow the pictures below for instructions.



Step 3: Install the Filter Cartridge

- Remove the shrink wrap from the filter cartridges. Place the filter cartridges back into the housings. Ensure they are centered and the knob protruding from the bottom of the housing fits in the central hole of the filter.
- Make sure the O-ring is seated inside the groove on top of the filter housing.
- Screw the filter housings, with the filter inside, onto the housing caps (caps are pre-assembled on the machine stand) in a counterclockwise direction (as viewed from above). The housing cap has a center knob, which should be inserted into the center hole of the filter cartridge. Twist the housing on by hand, then use the housing wrench to tighten it another 1/4 - 1/2 of a turn. Do not over tighten.



HOW TO CONNECT

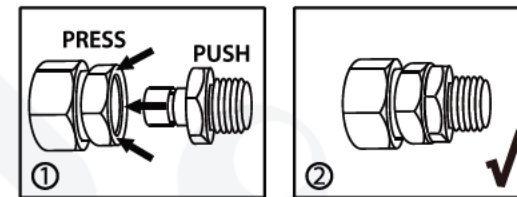

HOW TO DISCONNECT

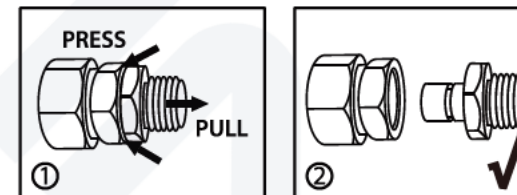

Step 4: Tubing Connection

Carefully follow the direction of the system to install the garden hose to the inlet and outlet of the car wash system. Twist the fitting by hand and then use a spanner wrench to tighten it as needed. Plumber's tape may be used to seal the tubing connection.

The garden hose quick connector could be used as needed for easier and faster tubing connection and disconnection.

During installation, make sure the O-ring is seated inside the female end of the connector.

Step 5: Flush the System

- Slowly turn on the cold water supply and check for leaks.
- Flush the system into a bucket.
- Wait for the outlet water flow rate to become stable, and then shut off the cold water supply. The system is now ready for use.